

ชั้นแสดงระบบ
4th Floor Plan

Handwritten signature and initials in blue ink.

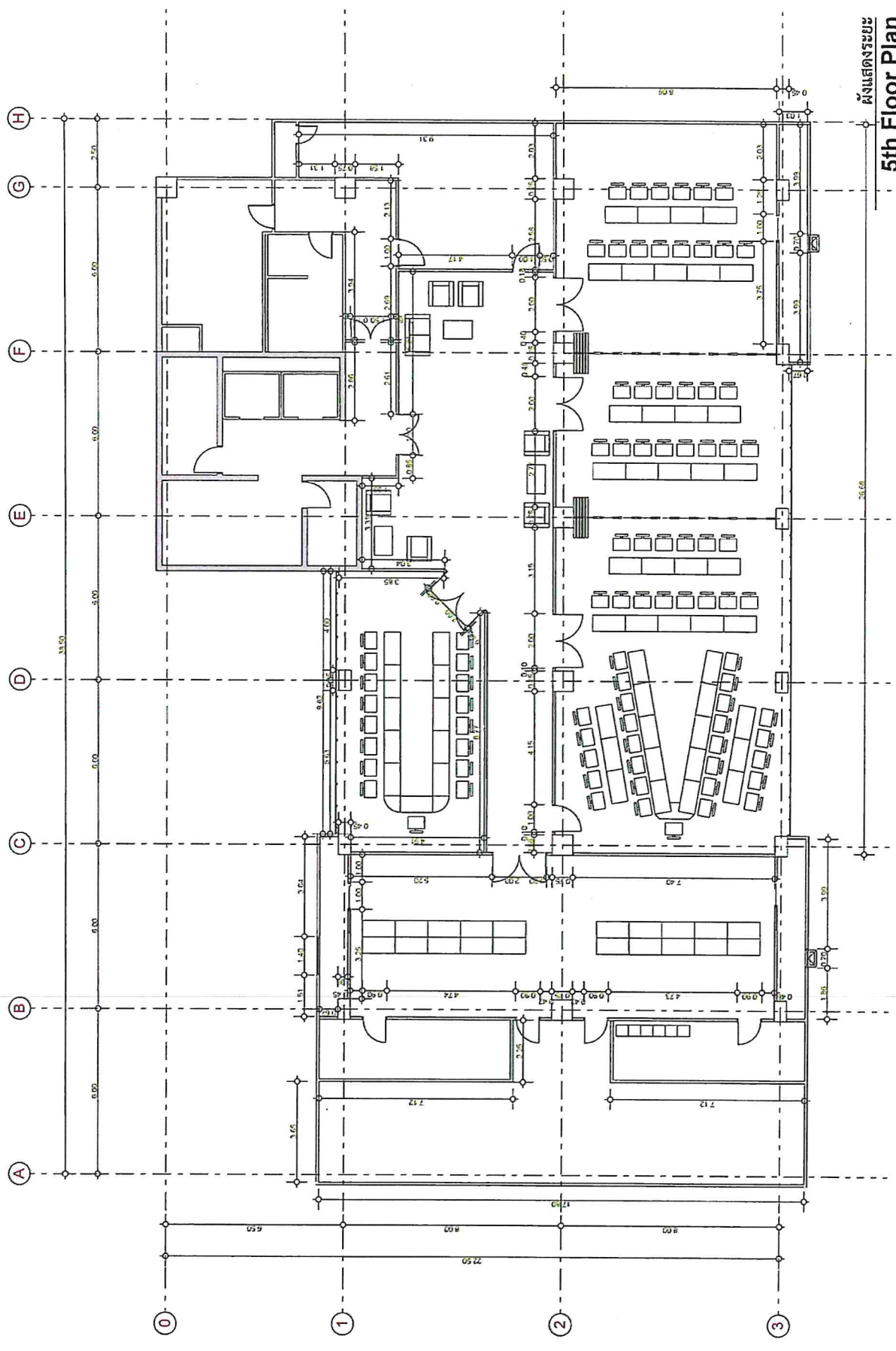

5th Floor Plan

Handwritten signature and initials in blue ink.

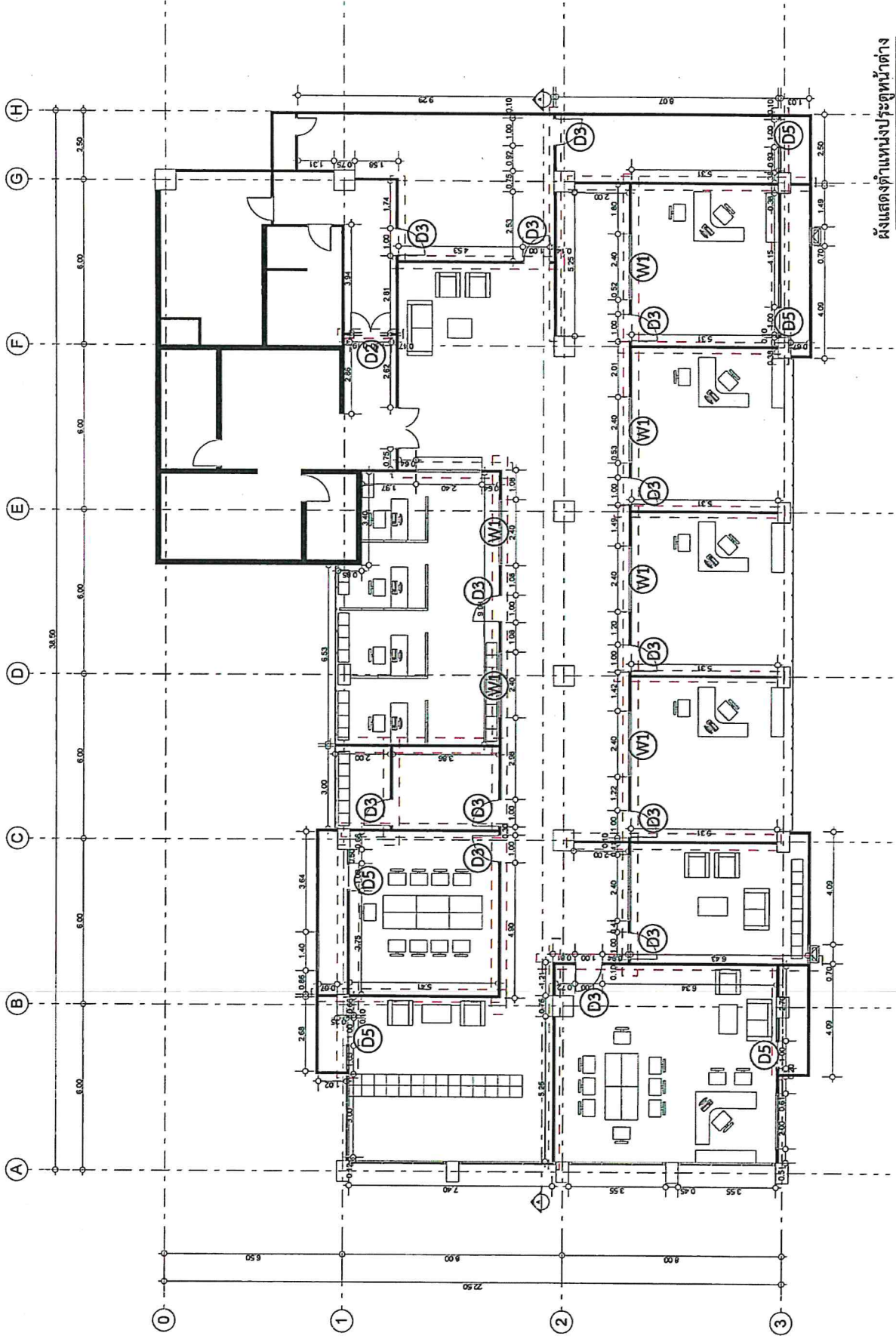

ผังแสดงตำแหน่งประตูหน้าต่าง
4th Floor Plan

Handwritten signature and initials in blue ink.

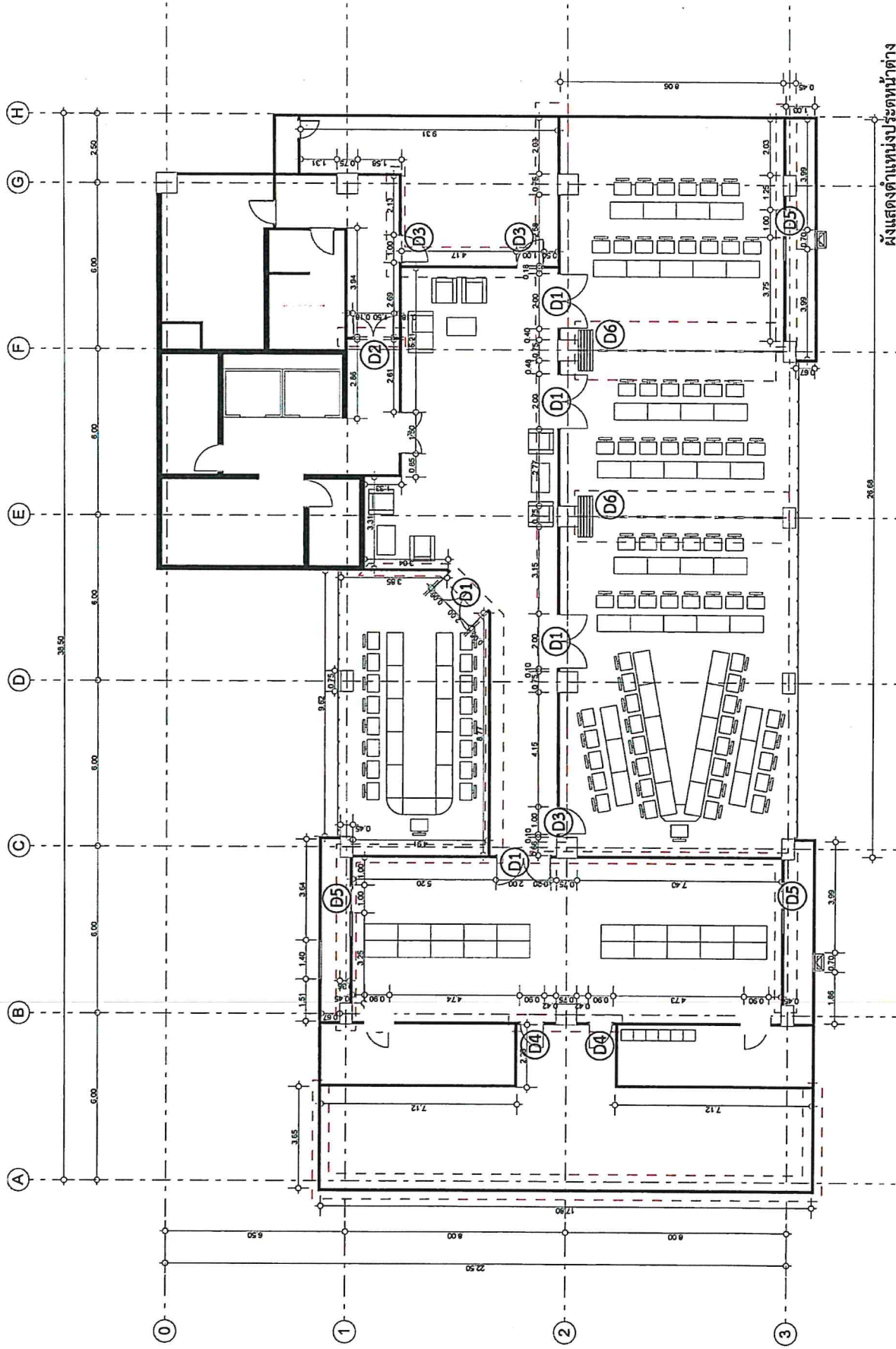

ผังแสดงตำแหน่งประตูหน้าต่าง
5th Floor Plan

Handwritten signature and initials in blue ink.